

Turnbuckles

- Used for batten trimming or tensioning lines.
- Drop forged turnbuckles meeting the requirements of ASTM F1145-92, Type 1, Grade 1, made in the U.S.
- Hot galvanized finish.
- Other types and sizes are available on special order.

Dimensions

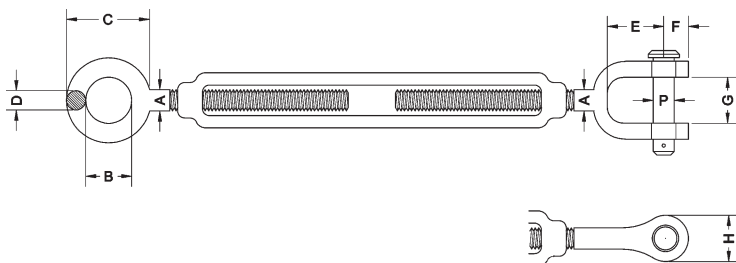

Turnbuckle
032-221J&E

Number	Dim. A	Dim. B	Dim. C	Dim. D	Dim. E	Dim. F	Dim. G	Dim. H	Dim. P	Closed Length
032-220J&E	5/16" (7.9 mm)	5/8" (15.875 mm)	1-1/4" (31.75 mm)	9/32" (7.1 mm)	7/8" (22.22 mm)	5/16" (7.9 mm)	15/32" (11.9 mm)	5/8" (15.87 mm)	1/4" (6.35 mm)	9-1/8" (232 mm)
032-221J&E	3/8" (9.5 mm)	3/4" (19 mm)	1-1/2" (38 mm)	11/32" (8.7 mm)	1" (25.4 mm)	13/32" (10.31 mm)	1/2" (12.7 mm)	13/16" (20.6 mm)	5/16" (7.9 mm)	11-1/2" (292 mm)
032-221J&J	3/8" (9.5 mm)	—	—	—	1" (25.4 mm)	13/32" (10.31 mm)	1/2" (12.7 mm)	13/16" (20.6 mm)	5/16" (7.9 mm)	11-1/2" (292 mm)
032-222J&E	1/2" (12.7 mm)	1" (25.4 mm)	2" (50.8 mm)	7/16" (11.1 mm)	1-9/32" (32.5 mm)	1/2" (12.7 mm)	5/8" (15.87 mm)	1" (25.4 mm)	7/16" (11.1 mm)	13-1/4" (337 mm)
032-223J&E	1/2" (12.7 mm)	1" (25.4 mm)	2" (50.8 mm)	7/16" (11.1 mm)	1-9/32" (32.5 mm)	1/2" (12.7 mm)	5/8" (15.87 mm)	1" (25.4 mm)	7/16" (11.1 mm)	19-1/4" (489 mm)
032-224J&E	5/8" (15.875 mm)	1-1/4" (31.75 mm)	2-5/16" (58.73 mm)	17/32" (13.5 mm)	1-21/32" (42 mm)	21/32" (16.67 mm)	7/8" (22.32 mm)	1-5/16" (33 mm)	1/2" (12.7 mm)	14-5/8" (371 mm)

Order Information

Number	Description	RWL	Weight
032-220J&E	5/16" x 4-1/2" (7.9 mm x 114 mm) Jaw & Eye Turnbuckle	800 lbs. (362 kg)	0.5 lb. (0.2 kg)
032-221J&E	3/8" x 6" (9.5 mm x 152 mm) Jaw & Eye Turnbuckle	1200 lbs. (544 kg)	1 lb. (0.45 kg)
032-221J&J	3/8" x 6" (9.5 mm x 152 mm) Jaw & Eye Turnbuckle	1200 lbs. (544 kg)	1 lb. (0.45 kg)
032-222J&E	1/2" x 6" (12.7 mm x 152 mm) Jaw & Eye Turnbuckle	2200 lbs. (1000 kg)	2 lbs. (0.9 kg)
032-223J&E	1/2" x 12" (12.7 mm x 305 mm) Jaw & Eye Turnbuckle	2200 lbs. (1000 kg)	2 lbs. (0.9 kg)
032-224J&E	5/8" x 6" (15.875 mm x 152 mm) Jaw & Eye Turnbuckle	3500 lbs. (1587 kg)	2.6 lbs. (1.18 kg)

RWL is based on the manufacturer's 5:1 safety factor.



Design, Manufacture and Installation of Theatrical Equipment Worldwide

For unusual applications, J.R. Clancy can create custom equipment to match your facility's specific needs. Please contact us to discuss your project's requirements.



© 2016 Wenger Corporation
USA/07-16/W



WENGER CORPORATION

Phone 800.4WENGER (493-6437) Worldwide 1.507.455.4100 | Fax 507.455.4258 Worldwide 1.507.774.8576
Parts & Service 800.887.7145 | Canada Office 800.268.0148 | Web wengercorp.com | 555 Park Drive, PO Box 448 | Owatonna | MN 55060-0448

GEARBOSS

Phone 800.493.6437 | email gearboss@wengercorp.com | Web gearboss.com | 555 Park Drive, PO Box 448 | Owatonna | MN 55060-0448

JR CLANCY

Phone 800-836-1885 Worldwide 1.315.451.3440 | Fax 877.836.1885 Worldwide 1.315.451.1766 | Web jrclancy.com
7041 Interstate Island Road | Syracuse | NY 13209-9713